

Reset

Reset the TV mount after installation using the following steps:

1. Press the down button on the control panel for 5 seconds until the screen shows 'RST'.
2. Keep pressing the down button until the column has gone down to its lowest height and then bring it back up a tiny amount. Please do not release the down button until the 'RST' disappears off the display.

When the 'RST' has disappeared, the setup process has finished.

Note: if the screen shows 'RST' during normal operation, please follow step 2 to reset the lift.

Set memory

Once the TV mount is installed, we suggest setting the desired flip angle using the memory functions.

1. Operate the TV mount to the desired flip angle that you want to set the memory function to.
2. Press button 'S' on the lift control panel or 'M' on the remote controller for 3 seconds till the screen shows 'SET'.
3. Press a number (e.g. 1 or 2 on the remote or 1,2,3 or 4 on the lift control panel) where you want to save the preset. (within 3 seconds after the screen shows 'SET')
4. The preset height is stored when the screen shows the 's-number' . (e.g. 'S-1')

Note: Once memory setup has been complete the Lift Control Panel can be unplugged (RJ45 Ethernet plug) if it is not required by the user. The remote will continue to operate without it.

Error

If the screen shows 'ER1' , the cables are probably not connected correctly. Please check and reconnect all cables.

After re-connecting the cables, press the down button for 3 seconds and follow the above reset steps.

Pairing remote controller

If the remote control is not working, please follow the below steps:

1. The pairing window time is 3 seconds after the system is powered on. The end of the pairing window period is identified by a single beep
2. During the 3 second pairing window, press & hold the "up" button of the remote control, wait for 4 long beeps and 3 short beeps to signal that pairing has been completed
3. After the pairing completion confirmation beeps, release the "up" button
4. The lift control system will now recognize the remote control.

Note: If during normal operation the TV mount encounters a sudden change in load, the controller will retract in order to prevent damage to the unit.

SUREMOUNT®



Installation Instructions For Motorised Fold Down Ceiling TV Mount

SMFDC30

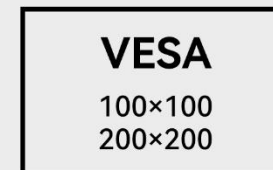
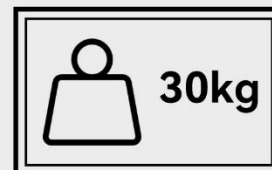

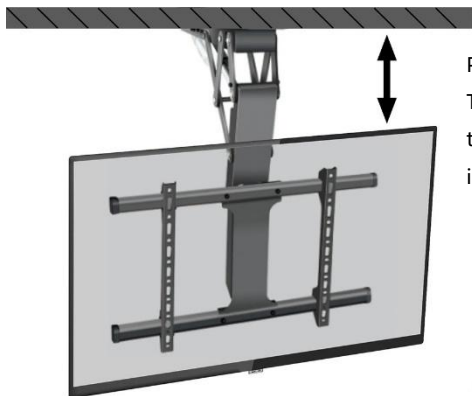

Please check your measurements when installing the TV lift to ensure there is sufficient space between the top of the TV and the ceiling to avoid any interference/collisions.



Warning

Supplied Parts and Hardware

A $\Phi 7 \times \Phi 10 \times 60\text{mm}$ 	B $M7 \times 60\text{mm}$ 	C $M8 \times 16\text{mm}$ 	D $M5 \times 10\text{mm}$ 	E $M6 \times 30\text{mm}$
F $M6$ 	G $\Phi 8 \times \Phi 17 \times 1.7\text{mm}$ 	H $M4 \times 20\text{mm}$ 	I $M6 \times 30\text{mm}$ 	You may need extra tools

Connect the cables as the below order

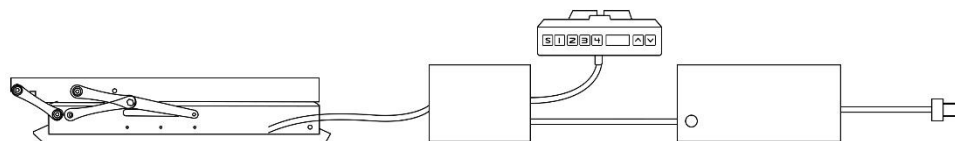

1. Connect to the power supply and adjust it to the open state.

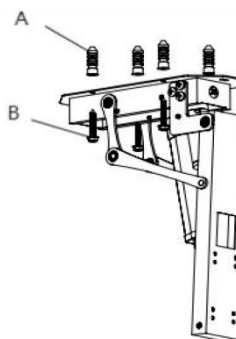

2. Place the bracket wall panel to where it is to be installed, mark the hole position and drill the hole, put the expansion tube into the hole, and pass the expansion screw through the wall panel to fix the bracket body.

Note: Installing into solid timber or concrete will ensure the lift unit is secured appropriately to the ceiling.

3. Assemble the TV hanging frame

①Insert the two horizontal beams into the upper & lower holes on the two vertical TV arms and connect with screws (D).

②Attach the stopper screws (D) to the ends of the horizontal beams.

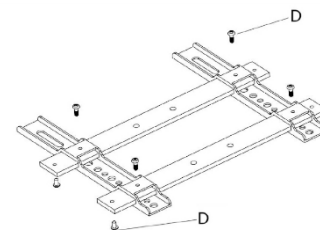

③Secure the cross-brace to the main frame using bolts(E) and nuts(F).

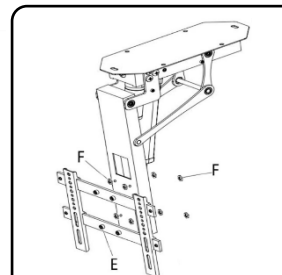
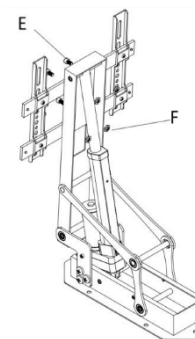

For Vesa 100×100mm, please add one nut F under the cross beam in order to lift the beam and let the hook to move inside more.

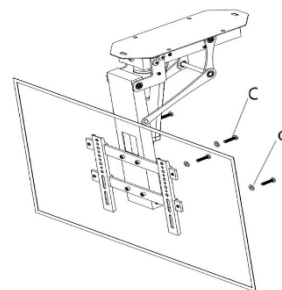

4. Select the appropriate holes for the two vertical arms of the assembled frame. And connect frame to the holes on the back of the TV. Select screws from (C, H or I) and install the screws with washers (G) on the upper and lower arms respectively.

Notice: The above installation steps are for reference only. Whilst all endeavors are made to ensure the accuracy of the drawings and the parts depicted, these may differ from the unit supplied. Please ensure that all screws & nuts are tightened during installation. For your safety, please do not exceed the size and/or weight limits for this TV ceiling mount. Please also ensure that the load bearing of the ceiling (or surface that the mount is being affixed to) is suitable for the weight & size of your screen. SureMount takes no responsibility for the installation of this motorized ceiling mount & recommends that you consult a professional TV installer to ensure that your safety & the integrity of your building is protected.